



The fast, hygienic and energy efficient hand drying system.

The Ecohand hand dryer uses a powerful, high-speed layer of clean air to eliminate every drop of water from the hands, leaving them dry in just 10 seconds. The innovative design prevents water droplets from falling to the ground, guaranteeing higher standards of hygiene.

**Advantages**

- Fast. Dries in just 10 seconds.
- Hygienic.
- Energy efficient.
- Environmentally friendly.
- Reduced CO<sub>2</sub> emissions.
- Automatic operation. Controlled by an intelligent infrared sensor that automatically turns the unit on and off.
- CPU controlled brushless motor (no carbon brushes).
- Anti vandal degree IK10.
- Large LCD display indicating the processand drying time.
- Easy to clean and maintain. Easy acces to water collection tray.
- Robust, impact-resistant housing.
- Economic and durable.
- Intelligent, practical and elegant design.
- Air intake filter.



**TECHNICAL CHARACTERISTICS**

Model	Voltage (V) 50Hz	Power (W)	Current (A)	Airflow (m <sup>3</sup> /h)	Air speed (m/s)	Insulation/ Protection	Anti vandal degree	Sound pressure level* (dB(A))	Dimensions LxWxH (mm)	Weight (kg)	Colour	Electric scheme**
ECOHAND	220-240	850	6,5	150	86	Class I / IP22	IK10	80	650 x 292 x 250	11	White	36

\* Sound pressure level measured at 1,5 m at free air conditions.

\*\* See section Electric Schemes.

### ENERGY CONSUMPTION

Use per day	ECOHAND hand dryer annual energy consumption (kW)	Traditional hand dryer annual energy consumption (kW)	Annual energy savings (kW)	Energy savings over 5 years (kW)
500 Times	430	4.055	3.625	18.125
1.000 Times	860	8.111	7.251	36.255
1.500 Times	1.290	12.166	10.876	54.380
2.000 Times	1.720	16.222	14.502	72.510

**Note**  
Ecohand hand dryer has been tested at 850W power, with an average drying time of 10 seconds on each occasion.  
A traditional 2000W hand dryer takes an average drying time of 40 seconds on each occasion.

### HOW IT WORKS

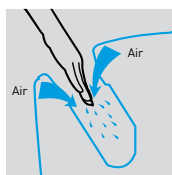

**1** Insert your hands in the slot. If you do not place your hands deep enough inside the slot, the LCD display will light up and indicate that you need to place your hands further inside.



**2** The LCD display will show a picture of a fan and the device will start to dry your hands. The timer will count from 0 to 10 seconds. The air will dry the water from your hands and the device will then stop automatically.



**3** Slowly remove your hands from the slot. The device will stop automatically.

