

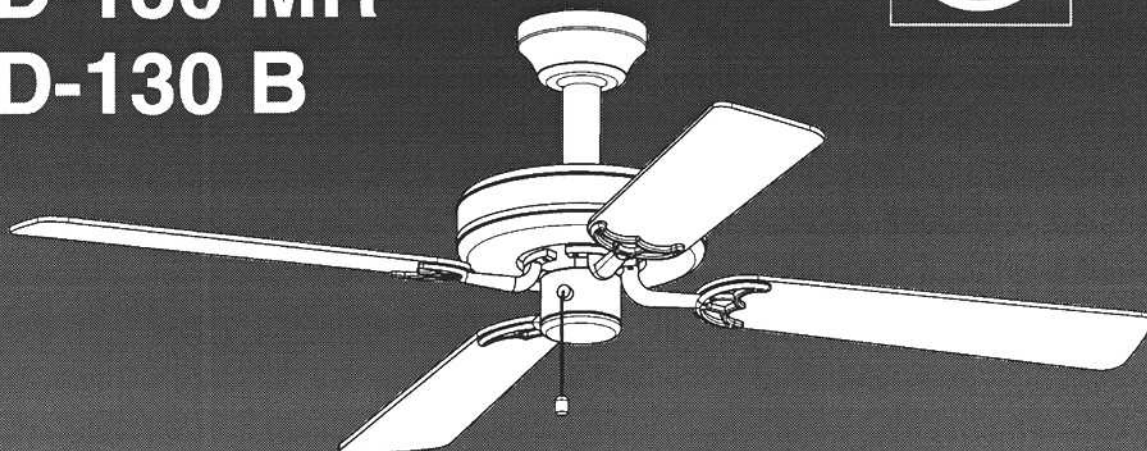

HTD-130 MR
HTD-130 B

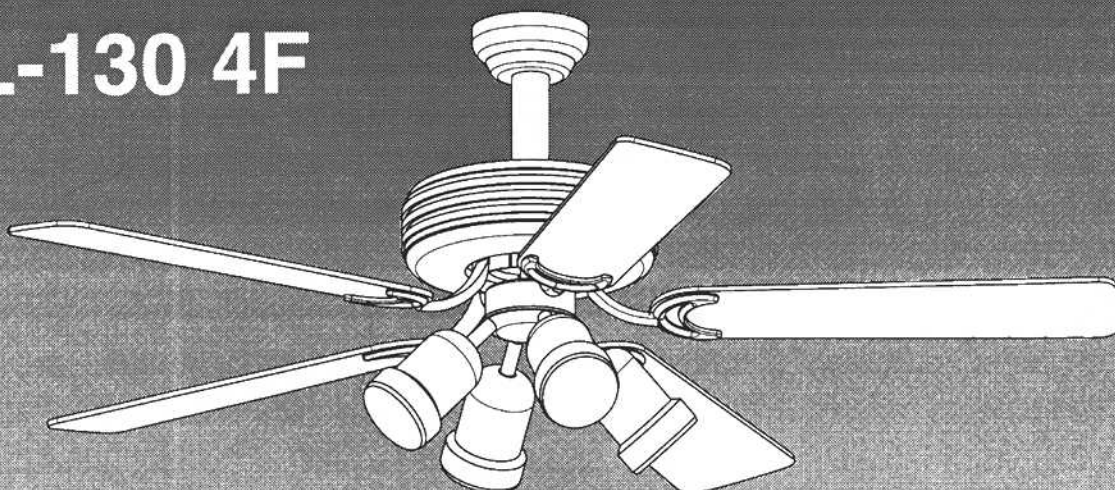

HTL-130 4F



HTL-130 1G

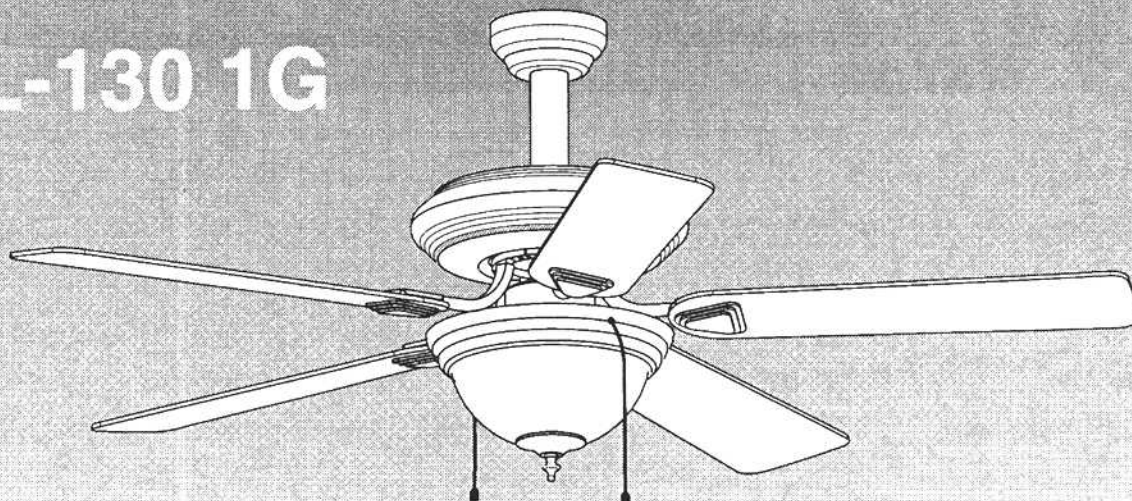

MANUAL DE INSTALACIÓN E INSTRUCCIONES DE USO
INSTALLATION MANUAL AND OPERATING INSTRUCTIONS
NOTICE D'INSTALLATION ET D'UTILISATION
MANUAL DE INSTALAÇÃO E INSTRUÇÕES DE USO
MANUALE D'INSTALLAZIONE E ISTRUZIONI
MONTAGEANLEITUNG UND GEBRAUCHSANWEISUNG

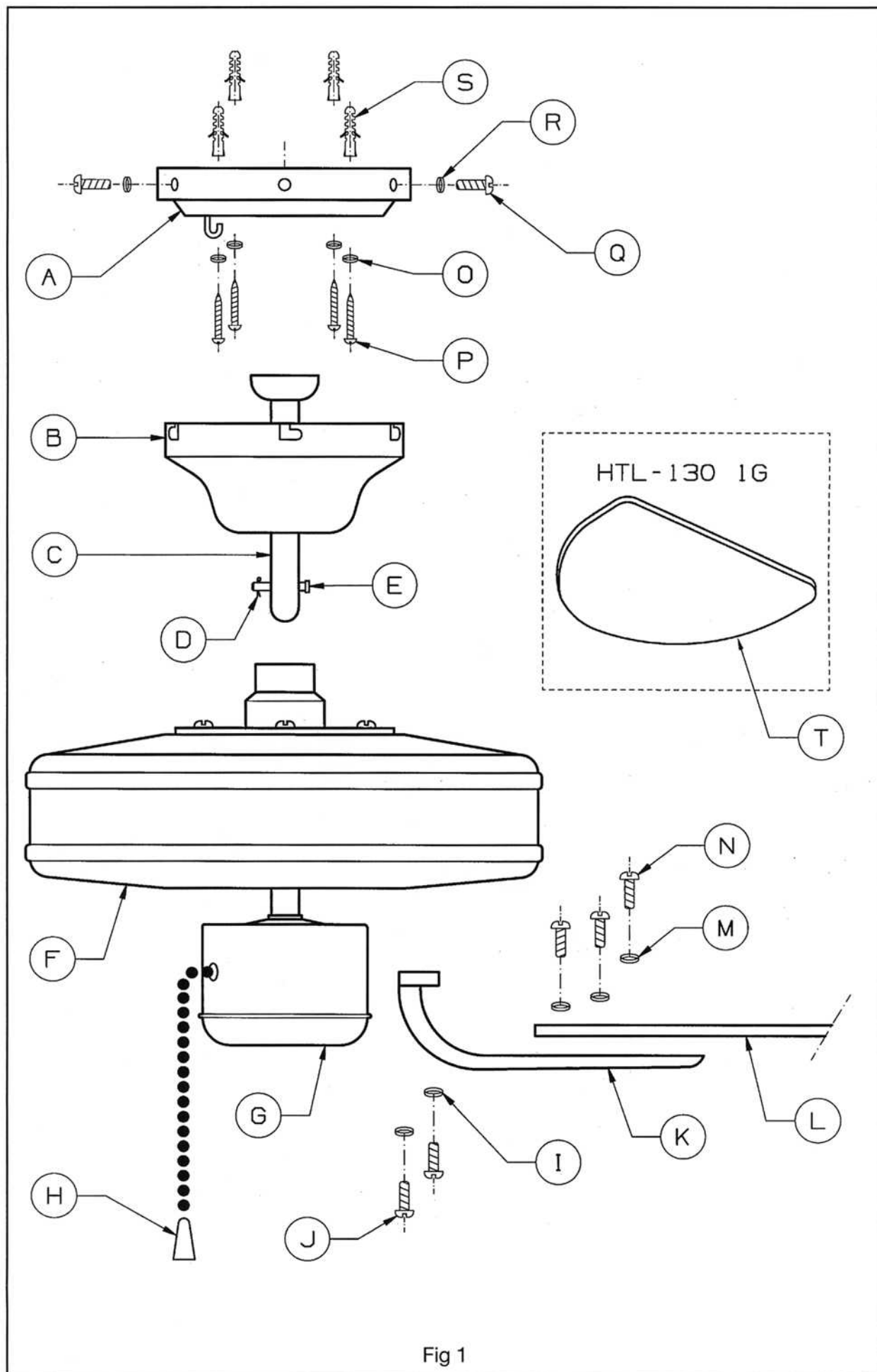

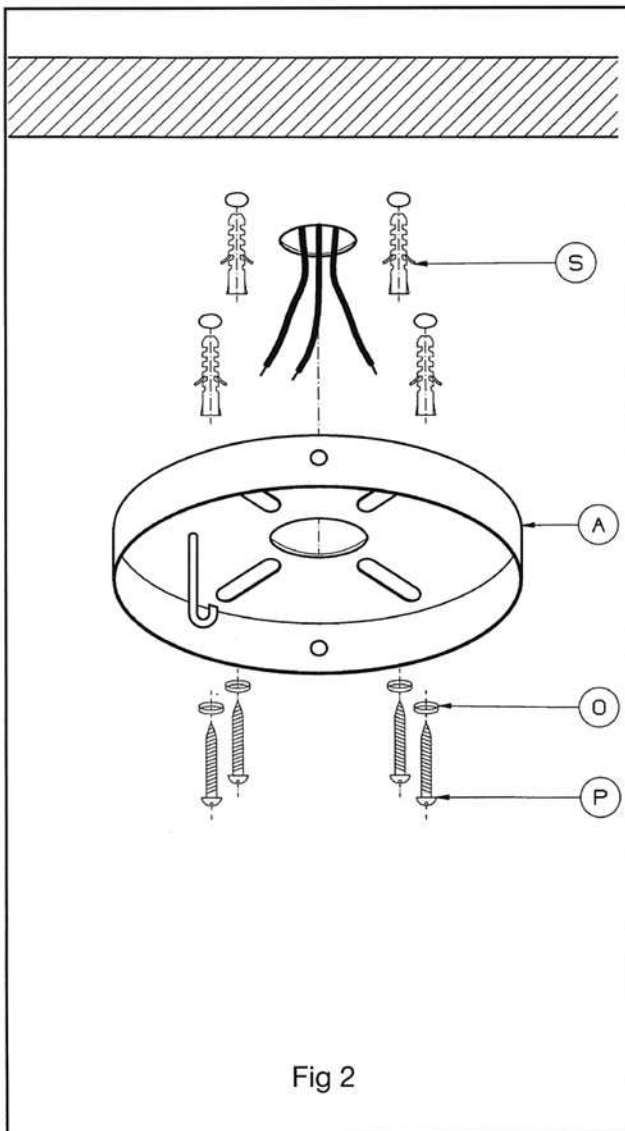

Fig 2

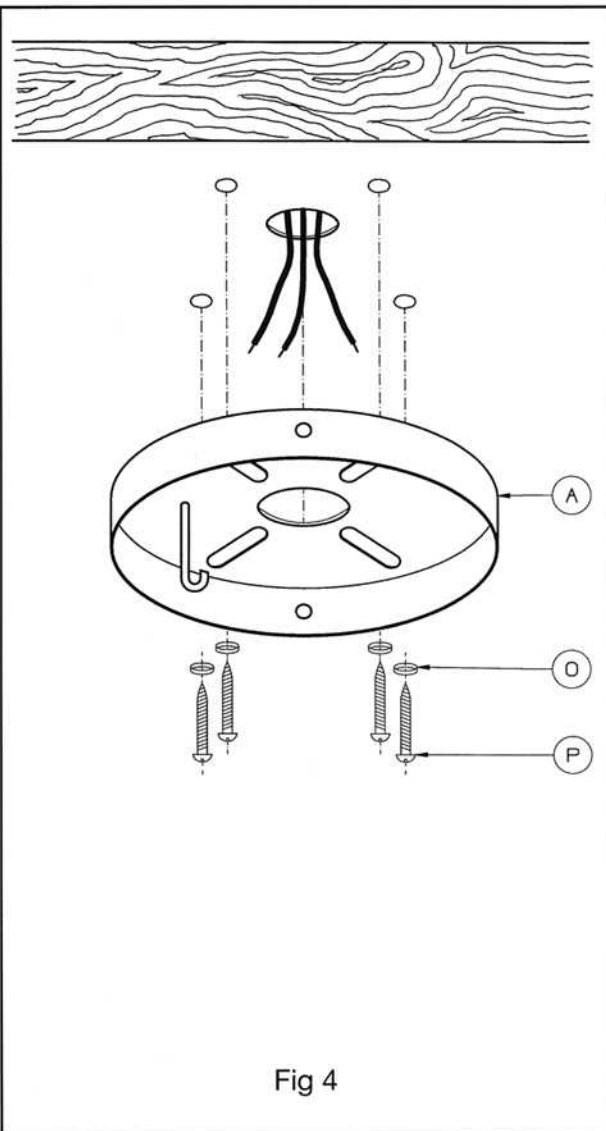

Fig 4

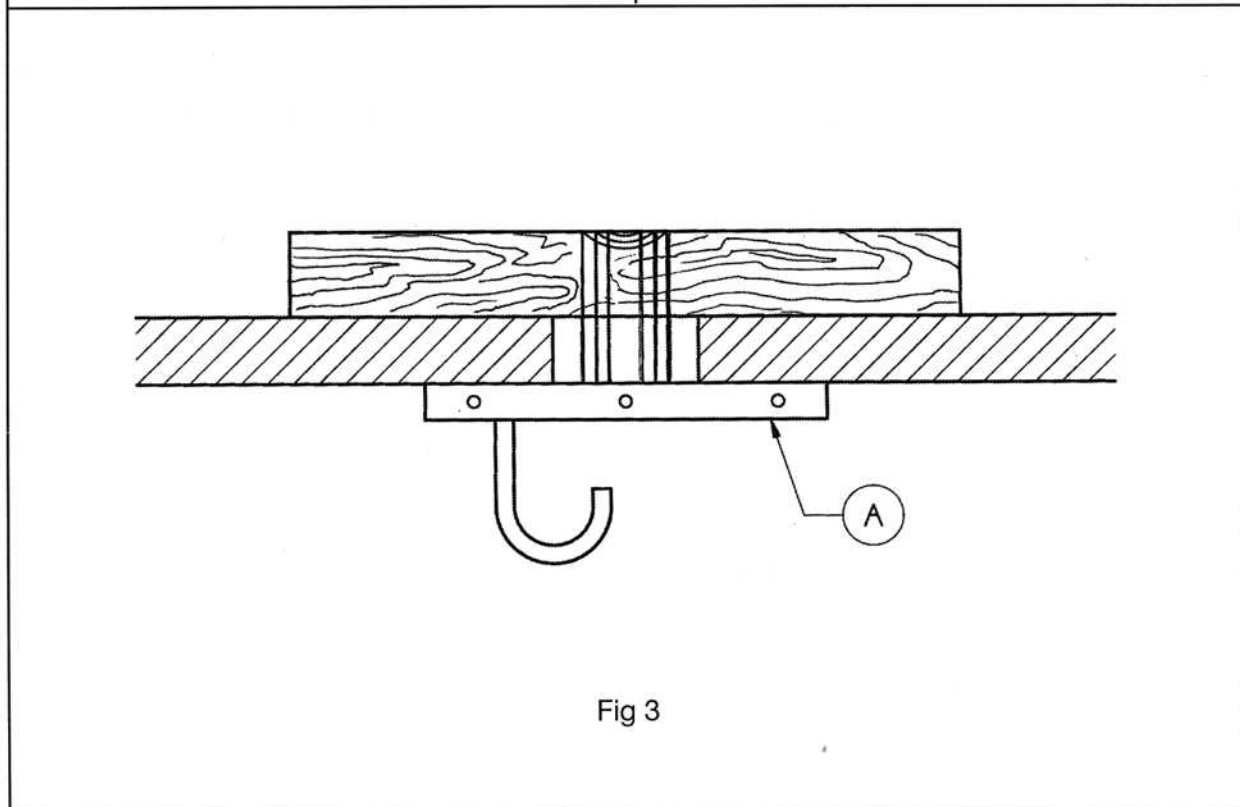
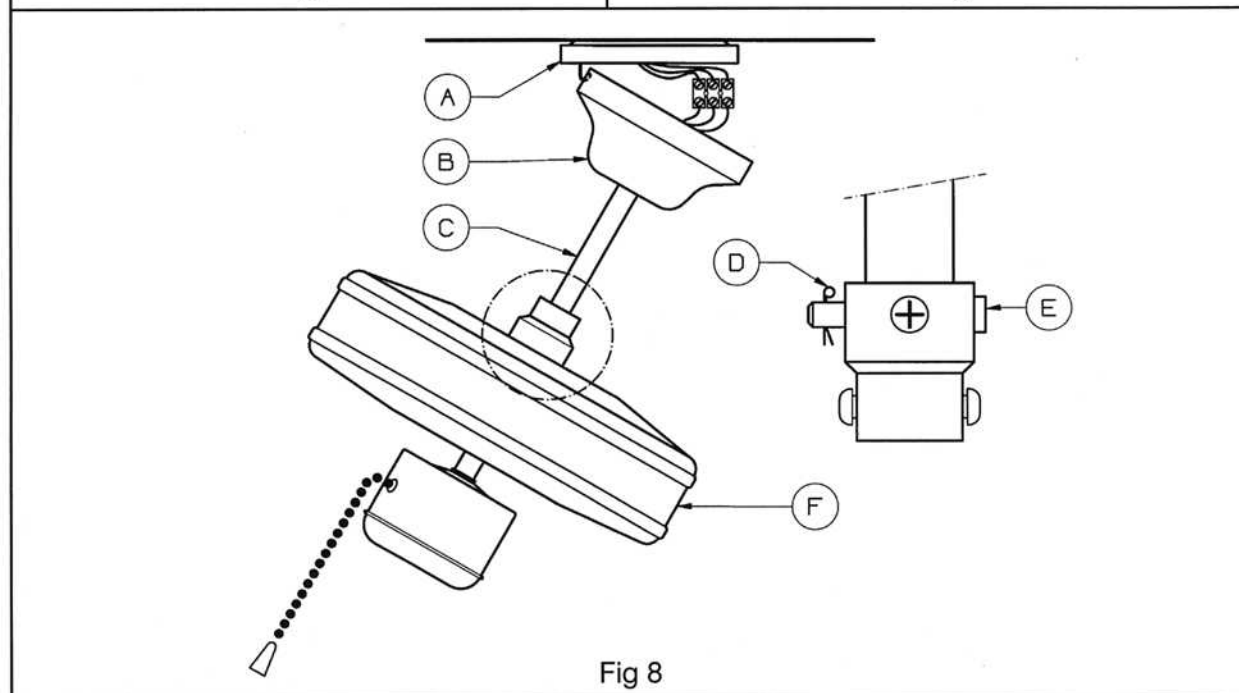
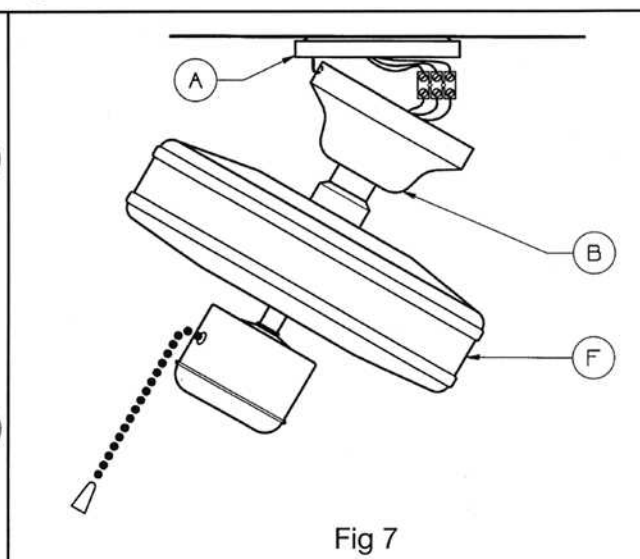
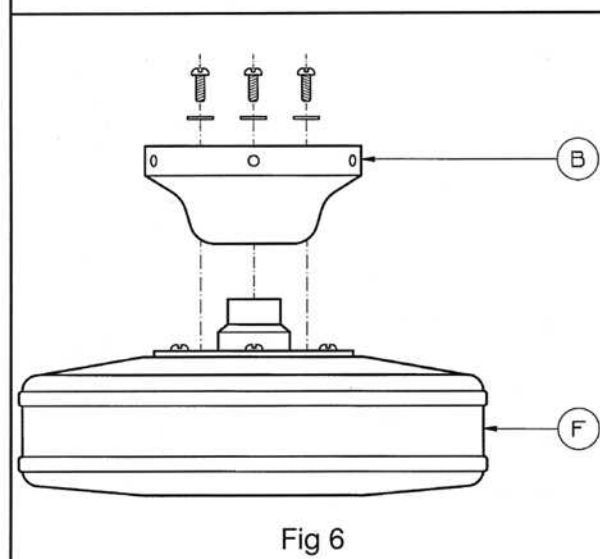
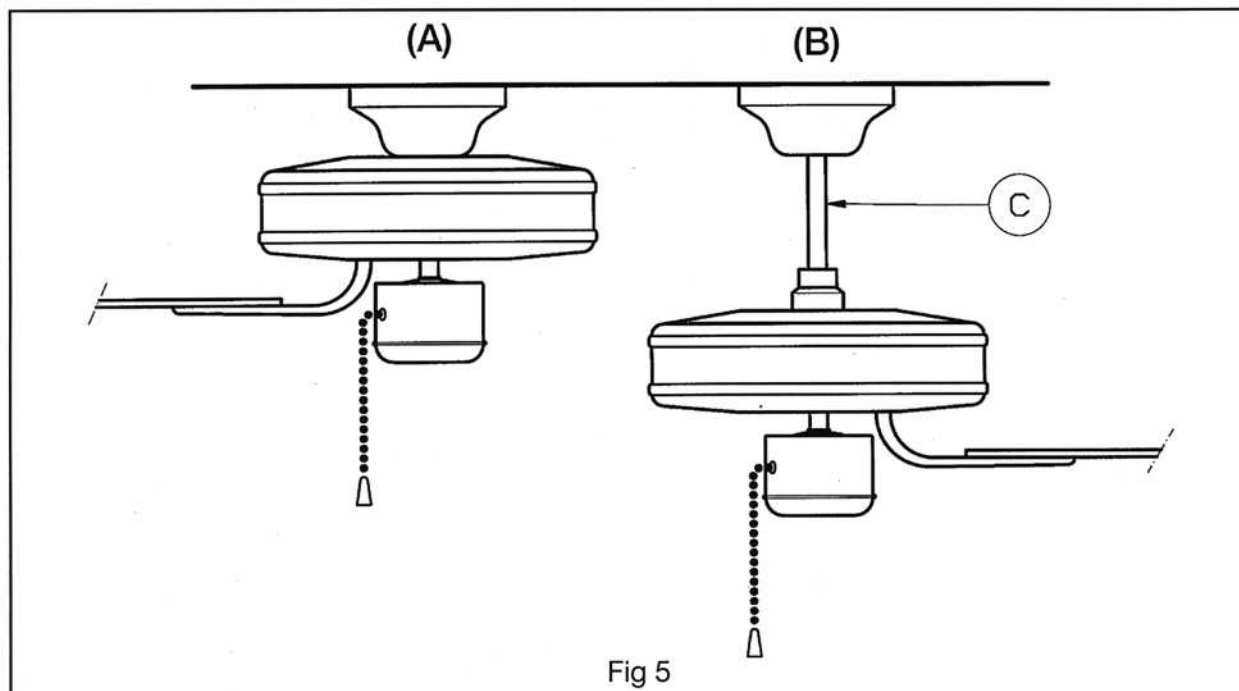

Fig 3



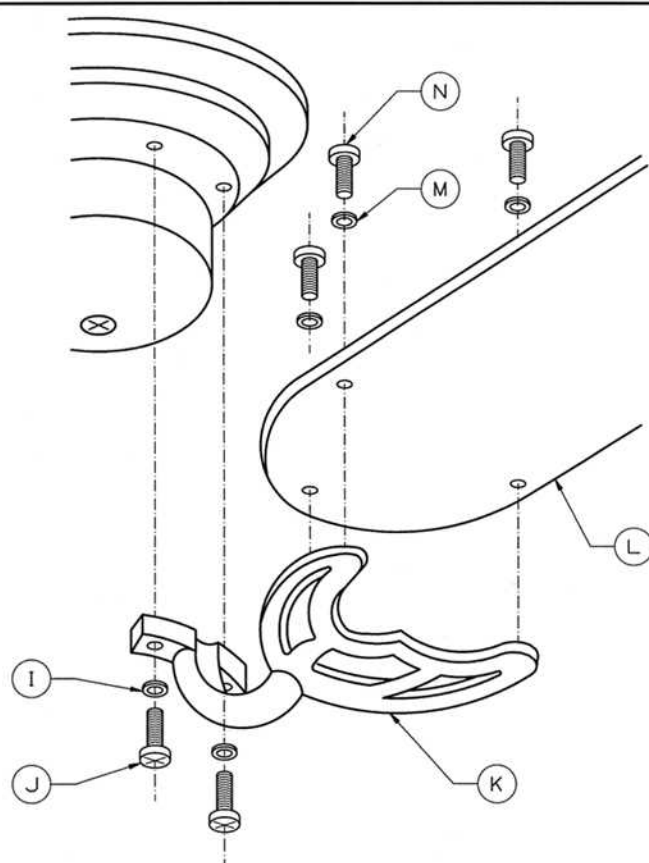
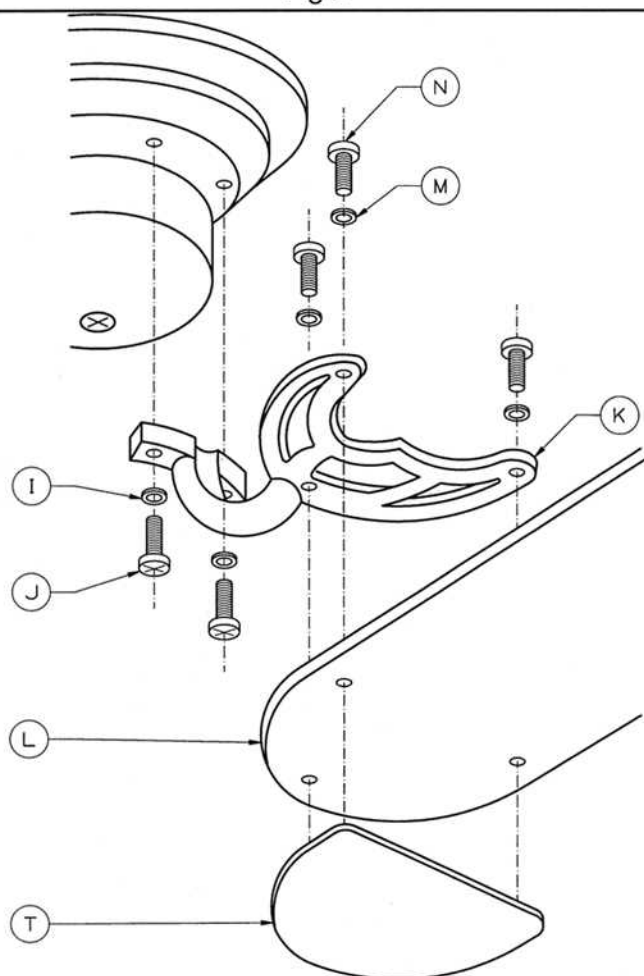

Fig 9



MODELO HTS-130 1G

Fig 10

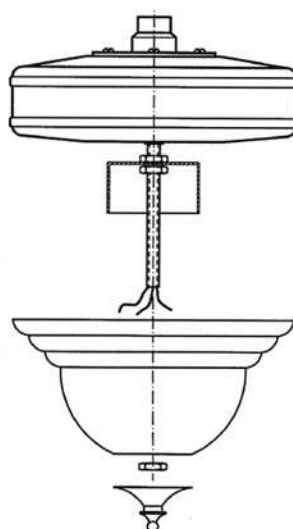
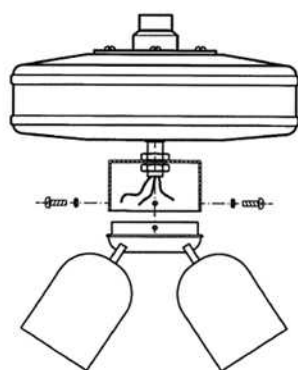
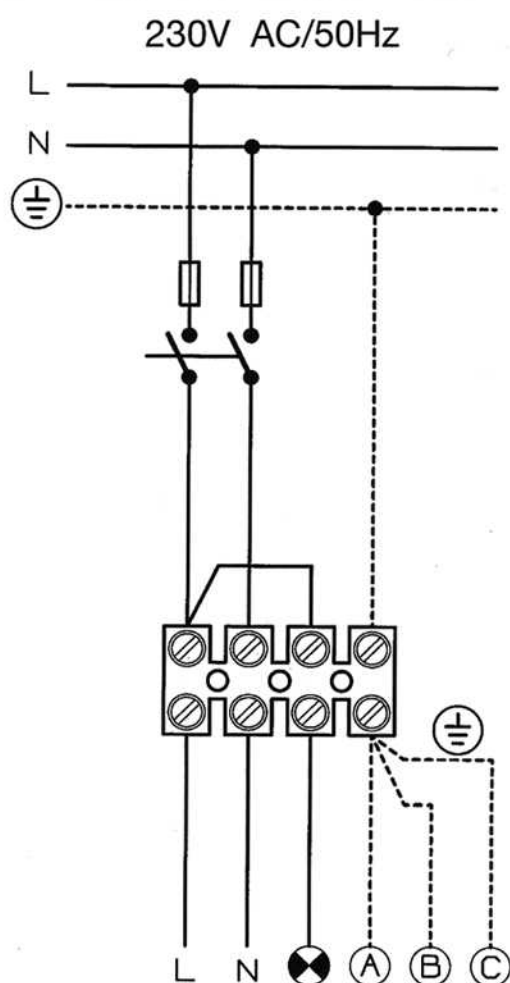

Fig 11



L : MARRON
 N : AZUL
 ● : ROJO (KIT DE LAMPARA OPCIONAL)
 ⊕ : A - AMARILLO-VERDE MOTOR
 B- AMARILLO-VERDE CARCASA
 C- AMARILLO-VERDE SOPORTE TUBO (OPCIONAL
 INSTALACION CON SOPORTE)

L : BROWN
 N : BLUE
 ● : RED (LAMP KIT OPTIONAL)
 ⊕ : A - GREEN-YELLOW MOTOR
 B- GREEN-YELLOW HOUSING
 C- GREEN-YELLOW TUB SUPORT (SUPPORT
 INSTALLATION OPTIONAL)

L : MARRON
 N : BLEU
 ● : ROUGE (KIT DE LAMPE OPTIONEL)
 ⊕ : A - JAUNE-VERT MOTEUR
 B- JAUNE-VERT CARCASSE
 C- JAUNE-VERT TUBE SUPORT (SUPORT
 AVEC INSTALLATION OPTIONEL)

L : CASTANHO
 N : AZUL
 ● : VERMELHO (KIT DE LÂMPADAS OPCIONAL)
 ⊕ : A - VERDE-AMARELO MOTOR
 B- VERDE-AMARELO CARCASSA
 C- VERDE-AMARELO SUPORTE TUBO (OPCIONAL
 PARA INSTALAÇÃO COM SUPORTE)

L : MARRONE
 N : BLU
 ● : ROSSO (LAMPADA OPZIONALE)
 ⊕ : A - GIALLO-VERDE MOTORE
 B- GIALLO-VERDE CORPO
 C- GIALLO-VERDE SUPPORTO TUBO (INSTALLAZIONE
 CON SUPPORTO TUBO OPZIONALE)

L : BRAUN
 N : BLAU
 ● : ROT (WAHLWEISE LAMPENSATZ)
 ⊕ : A - GELB-GRÜN MOTOR
 B- GELB-GRÜN GEHÄUSE
 C- GELB-GRÜN HALTEROHR(WAHLWEISE
 MONTAGE MIT HALTEROHR)

Fig 12

ENGLISH

Caution : For safe operation and installation, read all instructions carefully.

Neither the manufacture nor the manufacturer's agent/distributor nor the retailer from whom this product was purchased shall be in any way responsible for any loss or damage of whatever nature caused by the installation of this product.

GENERAL SAFETY RULES

To ensure the success of the Ceiling Fan's installation, be sure to read the following general safety rules before beginning.

- 1- The Ceiling Fan installation should be carried out by a qualified electrician.
- 2- To ensure a correct installation, be sure to read the instructions and review the diagrams thoroughly before commencement.
- 3- All electrical connections must be carried out in accordance with local codes and regulations, or the national Electrical Code. If you are unfamiliar with the installation of electrical wiring, secure the services of a qualified electrician.
- 4- Electrical supply 230V AC 50 Hz.
- 5- This apparatus must be earthed.
- 6- The method of disconnection from the mains supply must incorporate a switch or isolator with a minimum contact separation of 3 mm.on all poles.
- 7- Make sure that when the fan is fitted in the chosen position, there is no possibility of the rotating blades coming into contact with any object. Blades should be at least 2.30 m from floor when fan is hung.
- 8- If you are installing more than one ceiling fan make sure that you do not mix fan blade sets, even though they are from the same ceiling fan model.
- 9- Before beginning, disconnect power by removing fuse or turning off circuit breaker.
- 10- Once fan installation is completed make sure that all connections are secure to prevent fan from falling.
- 11- Do not insert anything into the fan blades when ceiling fan is operating.
- 12- Fan must be turned off and stopped before reversing fan direction.

IMPORTANT NOTE : The warnings, safeguards and instructions given in this manual are not exhaustive and do not necessarily cover all eventualities. It must be understood that common sense, caution and care are factors which cannot be built into any product. These factors must be supplied by the person(s) caring for and operating the unit.

UNPACKING INSTRUCTIONS

Before assembling the ceiling fan, remove all parts from the shipping carton and check them against the parts listed below (fig. 1) :

MODEL	A	B	C	D	E	F	G	H	I	J	K	L	M	N	O	P	Q	R	S	T	LAMP
HTL-130 1G	1	1	1	1	1	1	1	2	10	10	5	5	-	15	4	4	4	4	4	5	KIT 1
HTL-130 4F	1	1	1	1	1	1	1	2	10	10	5	5	15	15	4	4	4	4	4	-	KIT 4
HTD-130MR	1	1	1	1	1	1	1	1	8	8	4	4	12	12	4	4	4	4	4	-	-
HTD-130 B	1	1	1	1	1	1	1	1	8	8	4	4	12	12	4	4	4	4	4	-	-

- A- Hanging plate
- B- Upper Canopy
- C- Support downrod
- D- Cotter pin safety dowel
- E- Cotter pin
- F- Motor
- G- Switch housing assembly
- H- Switch housing
- I- Washers
- J- Screws
- K- Blade brackets
- L- Blades
- M- Washers
- N- Screws
- O- Washers
- P- Screws
- Q- Screws
- R- Washers
- S- Wall plugs
- T- Blade fixing bracket
- Balancing kit
- Instructions Manual
- Guarantee Card

INSTALLATION INSTRUCTION

FITTING THE FAN TO THE CEILING

Important: To avoid the possibility of accidents cause by the fan, which could imply legal responsibilities for the installer, compliance with each of the following instructions is essential.

Ensure that the distance between the lowest point of the fan, once installed, and the floor is at least 2.3 metres.

Check that the means of fitting the fan to the ceiling is capable of supporting the weight of the fan when in operation. (Minimum 25Kg.).

Fitting to a concrete ceiling

To ensure correct installation, drill four holes of the same diameter as the wall plugs (S) in the concrete ceiling. Insert the plugs supplied and fix the support plate (A) using the four screws (P) and washers (O) provided. (Fig.2).

Fitting to a false ceiling

Make a hole in the false ceiling that is large enough to allow the introduction of a rigid, wooden or metal cross beam. This should be as long as possible and under no circumstances less than 25cm. in length, to allow the best distribution of the weight of the fan.

Without reducing its ability to support the fan, make a small groove at the centre of the crossbeam, then locate the beam so that its centre coincides with the hole in the ceiling.

Join the support plate (A) to the crossbeam using galvanised metal wire of at least 2.5mm in diameter. Passing the wire through the grooves in the plate, wind it around the crossbeam and back through the plate a minimum of six times, so that at least some of the turns pass through the groove in the crossbeam. Secure the wire by twisting it around itself several times.

Ensure that the ceiling is able to support the weight of the fan in movement (minimum 25Kg.). (Fig.3)

Fitting to a wooden beam

Four screws (P) are supplied together with safety washer's (O) for fitting the support plate (A) to a wooden beam. The holes for the screws should not be of greater diameter than the diameter of the screw. Ensure that the wooden beam is able to support the weight of the moving fan (minimum 25Kg.) (Fig.4)

ASSEMBLY OF THE FAN

IMPORTANT: If you are installing more than one ceiling fan make sure that you do not mix fan blade sets, even though they are from the same ceiling fan model.

1. Select type of installation - flush fitting or fitting with support downrod.

Your fan is supplied with a support downrod (C), which allows fitting to standard ceilings or in rooms with low ceiling heights. Choose the system which best suits to your needs.

Flush fitting (Fig.5A)

1. Assemble the fan motor (F) and the canopy (B). The three larger holes in the canopy should be aligned with the three screws in the motor upper housing. (Fig. 6)
2. Fix the canopy using the three screws and safety washers supplied (Fig.6)
3. First fix the support plate(A) to the ceiling using the screws (P) and the wall plugs (S) then attach the fan to the hook on the back plate using the hole in the canopy (B) In this way the electrical connections can be made between the mains supply cables and the fan connectors. (Fig. 7) (Fig. 12)

IMPORTANT : The red cable in the fan is part of a separate circuit to be used with the lamp kit. (depending on model). If you have a model with lamp kit, the red cable should be connected to the L connection (brown). For non lamp versions, the red cable should be ignored. (Fig.12)

4. Complete the assembly of the fan/wall plate by fixing the canopy using the four screws (Q) and the safety washers (R) supplied. Ensure that the screws are well tightened (Fig. 1)

Fitting with support downrod (Fig 5B)

1. Pass the support downrod (C) through the canopy (B) ensuring that the notch on the canopy engages with the groove on the support downrod. (Fig. 8)
2. Pass the motor cables through the support downrod (C) assemble the downrod to the motor and insert the cotter pin (E), secure the cotter pin with the safety dowel (D) and tighten the

screws on both sides of the cotter pin (Fig. 8)

3. First fix the support plate(A) to the ceiling using the screws (P), and the wall plugs (S) provided then attach the fan to the hook on the back plate using the hole in the canopy (B) In this way the electrical connections can be made between the mains supply cables and the fan connectors (Fig. 8). (Fig. 12)

IMPORTANT: The red cable in the fan is part of a separate circuit to be used with the lamp kit. (depending on model). If you have a model with lamp kit, the red cable should be connected to the L connection (brown). For non lamp versions the red cable should be ignored. (Fig.12)

4. Complete the assembly of the fan/wall plate by fixing the canopy using the four screws (Q) and the safety washers (R) supplied. Ensure that the screws are well tightened (Fig. 1)

2- Fitting the fan blades

IMPORTANT: If you are installing more than one ceiling fan make sure that you do not mix fan blade sets, even though they are from the same ceiling fan model.

1.- a) Place the fan blade (L) on the floor with the chosen colour facing down. Use the felt washers (M) to avoid damage to the blade and join the blade to the blade support (K) using the screws supplied (N), but do not tighten fully (Fig. 9)

Once the screws and washers are in position for all blades, start to tighten the screws beginning with the screw in the centre of each blade. Ensure that the blade is straight.

b) (HTL 130-1 G Model) Place the fan blade (L) on the floor with the chosen colour facing down. Align the holes in the blade support (K), the blade (L) and the blade fixing bracket (T) . When the holes in all three components are aligned complete the assembly using the screws supplied (N), but do not fully tighten the screws (Fig.10)

Once the screws and washers are in position for all blades, start to tighten the screws beginning with the screw in the centre of each blade. Ensure that the blade is straight.

2.- Join the complete assembly to the motor using the screws (J) & the safety washers (I). Repeat the process with the rest of the blade assemblies. (Fig.9) or (Fig.10)

3.- The lamp kit can be installed at this time following the instructions provided (According to model). (See following page)

OPERATION INSTRUCTIONS

1.- The chain pull switch on the motor has four positions.

- 1) Pull once.... ON (High speed)
- 2) Pull again... ON (Medium speed)
- 3) Pull again... ON (Low speed)
- 4) Pull again... OFF

IMPORTANT: This product must not be used in conjunction with solid state control devices.

2.- The small sliding switch (on the side of the housing) controls the airflow direction. All fans are factory supplied with the switch in the downward airflow position. If you require the airflow in the opposite direction, switch the fan off, wait for it to stop and move the sliding switch to the opposite position. The fan will now rotate in the opposite direction and the airflow will be reversed.

3.- Lamp kit.

- 1) Pull..... ON
- 2) Pull again.. OFF

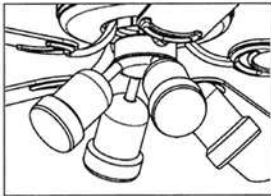
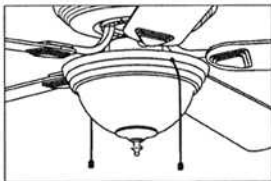
MODEL	LAMP KIT	MAXIMUM POWER
HTL-130 4F	MOVEABLE 	4x60W
HTL-130 1G		2x60W

Note: Light bulbs are not supplied.

ASSEMBLY OF THE LAMP KITS

IMPORTANT: Remember to disconnect the fan from the mains supply (mains fuse or contact breaker) before working on the fan.

- 1.- Connect the lamp kit cables using the lower fan electrical connectors. The cables are marked and should coincide with the correct connector.
- 2.- Fit the cables inside the assembly, align the holes of the two halves of the assembly and tighten the screws using the safety washers supplied. The HTL-130 1G has a decorative fitting to fix the glass globe. (Fig. 11)

NOTE: Remember to connect the red lamp cable and the mains supply connector (brown). (Fig.12)

MAINTENANCE

- 1.- Periodic cleaning is the only maintenance required.
- 2.- Clean the fan using a soft brush or soft cloth to avoid damaging the finish.
- 3.- When carrying out maintenance work, do not use the fan blades as a support as they could become unbalanced and so increase the vibration of the fan.
- 4.- Do not use abrasive cleaning agents as these could damage the finish of the fan.
- 5.- Do not use water when cleaning the fan as this could cause damage to the motor and deform the fan blades.
- 6.- Furniture polish can be used to clean wooden fan blades.

IMPORTANT: Before carrying out any maintenance work on the fan, ensure that it is disconnected from the mains electrical supply.

IMPORTANT: Before working on the fan, ensure that it is disconnected from the mains supply.

PROBLEM SOLVING

Problems	Probable cause	Suggested solution
Fan does not start	<ol style="list-style-type: none"> 1. Sliding direction switch in neutral position. 2. Blown fuse or circuit breaker. 3. Loose connections to the mains supply or the switch housing. 	<ol style="list-style-type: none"> 1. Ensure that the switch is set completely to one side. 2. Check fuses or circuit breaker. 3. Tighten connections
Fan sounds noisy	<ol style="list-style-type: none"> 1. Fan blades not attached to fan. 2. Loose screws in motor housing. 3. Loose screws securing fan blades to motor housing. 4. Contact between switch housing and motor housing. 5. Cable connector nuts loose in switch housing. 	<ol style="list-style-type: none"> 1. Fit blades before starting fan. 2. Ensure that screws are well tightened (not over-tightened) 3. Check fan blade screws for tightness. 4. Check and reposition switch housing if necessary. 5. Check to ensure that cable connectors are not vibrating against each other or against housing.
Fan shakes or vibrates excessively	<ol style="list-style-type: none"> 1. Loose screws securing fan blades to motor housing. 2. Fan blades not seated properly. 3. Support plate and/or ceiling support not securely fitted. 4. Fan blades out of balance. 	<ol style="list-style-type: none"> 1. Check fan blade screws for tightness. Tighten if necessary 2. Check the fan blades sit snugly in the motor housing. If this is not the case, loosen the screws and retighten following the instructions in section 2 of "Assembly of the fan" 3. Tighten the support plate or ceiling support screws. 4. Mark each blade with a piece of tape, and number them 1-4 (1-5). Remove the motor housing with blades attached. Change the position of the blades as shown below, until the problem is solved.
<p>Fan with 5 blades</p> <div style="display: flex; justify-content: space-around;"> <div style="border: 1px solid black; padding: 5px; text-align: center;"> <p>a 1 b 1 c 1</p> <p>5 2 5 3 5 3</p> <p>4 3 4 2 2 4</p> </div> <div style="border: 1px solid black; padding: 5px; text-align: center;"> <p>d 1 6 1 1 1</p> <p>2 3 2 5 4 3</p> <p>5 4 3 4 5 2</p> </div> </div>		<p>Fan with 4 blades</p> <div style="display: flex; justify-content: space-around;"> <div style="border: 1px solid black; padding: 5px; text-align: center;"> <p>a 1 6 2 0 2</p> <p>4 2 4 1 3 1</p> <p>3 3 4</p> </div> <div style="border: 1px solid black; padding: 5px; text-align: center;"> <p>d 1 6 1 f 1</p> <p>3 2 3 4 4 3</p> <p>4 2 2 2</p> </div> </div>

If adjustments do not correct the fan vibration or shaking, use the fan blade balancing kit supplied with your fan. (See instructions in Balancing Kit).

The balancing kit should only be used if the fan suffers unacceptable vibration or shaking after having taken the corrective measures outlined in the section "Fitting the fan blades" in the manual.

BALANCING KIT

1. Turn on the fan and select the fan speed selector position that causes the greatest amount of shake.
2. Turn off the fan and allow it to stop completely. Choose a blade and fit the balancing clamp at a central point between the holder and the tip, on the central ridge of the blade.
3. Turn on the fan. Check to see if the shaking has increased or decreased. Turn off the fan and repeat the procedure choosing a different blade. Repeat the process for all the blades checking on which blade the greatest improvement is produced.
4. Fix the balancing clamp once more on the blade that produced the best improvement. Move the clamp along the length of the blade and check the function of the fan until the point on the blade that produces the best result is found.
5. Remove the clamp and fit a balancing weight onto the top of the blade in the position where the clamp was fitted.
6. If the problem is not completely solved, you can try to reduce the shake further by using the balancing clamp and additional weights on the other blades.