

KITCHEN EXTRACTORS

K Series



CK-40F



CK-50



CK-60F

Description

The K Series range of centrifugal extractors are specifically designed for the extraction of moist, grease laden air and fumes from under domestic cooker canopies. The range offer powerful and quiet extract operation suitable for all domestic kitchen environments

The K Series fans are easy to install and maintain due to the flexible design and configuration. A comprehensive range of accessories is offered to complete the most demanding installations.

In a kitchen, the use of a cooker canopy enables the extraction of polluted air. The airflow required depends upon the canopy width and the distance between the canopy and the cooker. Within this cross-section the recommended air "capture velocity," must be between 0.15 and 0.25 m/s.

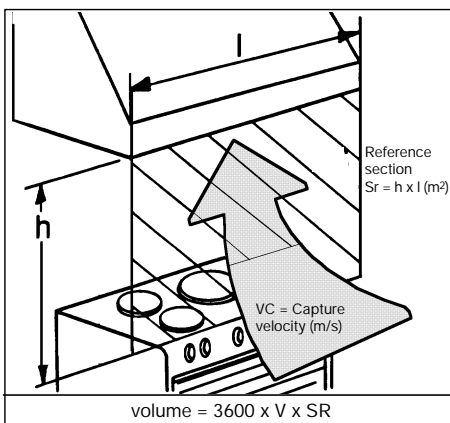

Range

This range consists on seven models with airflows ranging between 250 and 625 m³/h:

- CK-25N
- CK-35N
- CK-40F
- CK-50
- ECO-500
- CK-60F

Construction

Model CK-25N is manufactured from tough injection moulded plastic. The fan incorporates a single phase 230V 50Hz, fully speed controllable motor. All models are supplied with Class II insulation and an integrated Thermal Overload Fuse to protect against overheating.

Model CK-25N is manufactured from tough injection moulded plastic. The fan incorporates a single phase 230V 50Hz, fully speed controllable motor. All models are supplied with Class II insulation and an integrated Thermal Overload Fuse to protect against overheating.

The CK-25N, as standard incorporates a grease collection tray with a front fascia and fan impeller that can be removed for easy cleaning and maintenance (these parts can be cleaned in a dishwasher). The CK-25N model operates at an air flow performance of 250 m³/hr.

Model CK-35N is manufactured from sheet steel with an epoxy polyester paint finish. The fan incorporates a single phase 230V 50Hz, fully speed controllable motor with a Class II insulated rating. All models are supplied with Class II insulation and an integrated Thermal Overload Fuse to protect against overheating.

The CK-35N model is fitted with a metallic filter at the air inlet to prevent the build-up of grease within the fan and ducting enclosure. All models incorporate, as standard, a grease filter; grease collection tray and a front fascia and fan impeller that can be removed for easy cleaning and maintenance. The CK-35N model operates at an air flow performance of 350 m³/hr.

Model CK-40F is manufactured from tough injection moulded plastic. The fan incorporates a single phase 230V 50Hz, fully speed controllable motor, supplied with Class II insulation and an integrated Thermal Overload Fuse to protect against overheating. The CK-40F incorporate, as standard, grease collection tray and a front fascia and fan impeller that can be removed for easy

cleaning and maintenance. (these parts can be cleaned in a dishwasher).

In addition the CK-40F incorporates a metallic Teflon coated filter fitted to the inlet to improve filter efficiency and facilitate cleaning. The CK-40F has a maximum airflow of 360 m³/hr.

Model CK-50 and ECO-500 casings are manufactured from sheet steel with an epoxy polyester paint finish. The front grill, impeller and grease tray are manufactured from tough injection moulded plastic. The fans incorporate a single phase 230V 50Hz, fully speed controllable motor. All models are supplied with Class I insulation and an integrated Thermal Overload Fuse to protect against overheating.

Both models are suitable for large domestic kitchen extract applications where the removal of strong kitchen odours and large amounts of airborne grease / moisture are required. The front grille, impeller and grease tray can easy be removed for cleaning. The model CK-50 can be supplied with metallic filter to replace the standard inlet guard. The CK-50 and ECO-500 models operate at an air flow performance of 480 m³/hr.

Model CK-60F is manufactured from tough injection moulded plastic. The fan incorporates a single phase 230V 50Hz, two speed (fully speed controllable) motor. All models are supplied with Class II insulation and an integrated Thermal Overload Fuse to protect against overheating.

All models incorporate a grease filter, grease collection tray, impeller and front cover that can be removed without tools for easy cleaning and maintenance (these parts can be cleaned in a dishwasher).

The CK-60F incorporates a stainless steel filter fitted to the inlet to prevent the build up of grease in the fan and ducting enclosures and to facilitate cleaning. The CK-60F models operate at an air flow performance of 625 m³/hr at high speed and 415 m³/hr at low speed.

CK-25N



Applications

The CK-25N centrifugal fan has been specifically designed to remove the smoke, odours and grease laden air generated from domestic cooking areas (250 m³/hr capacity). The models can be installed either inside or external to a kitchen cooker canopy. They operate with very low levels of noise and offer easy cleaning and maintenance access. The versatile design also enables the fan to be used in other ventilation applications that require the extraction of moist, odour and grease laden air.

Performance curve

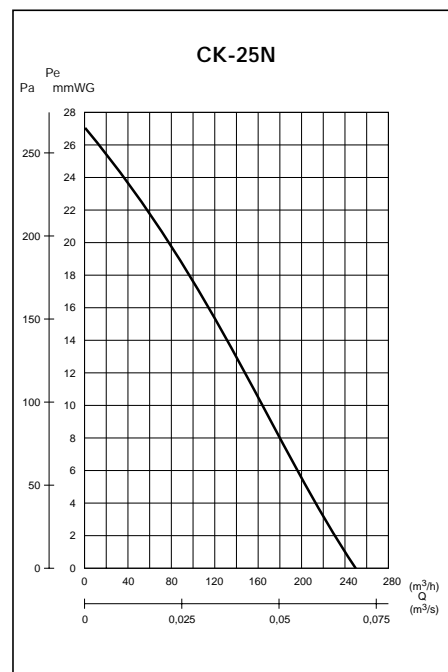

Technical characteristics

Model Type	Speed (r.p.m.)	Maximum absorbed power (W)	Voltage (V) 50 Hz	Max. air flow at free air (m ³ /h)	Sound pressure level (dB(A))*	Weight (kg)
CK 25N	2250	40	230	250	50	1,9

* At a 1,5 m distance.

Installation - Maintenance

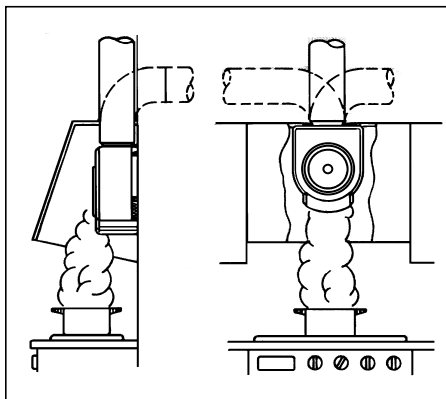

Dimensions (mm)

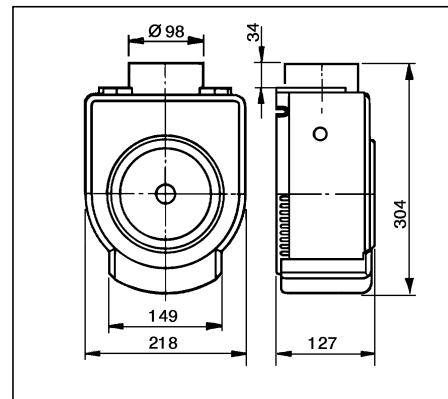

Accessories



GSA-100
Flexible aluminium ducting



GRA-70
Aluminium exterior grill



REB
Single phase electronic fan speed control regulators



CX-125
Worm drive ducting clips



CAR-100
In-duct back draft shutter



CT
Roof Cowl



PER-100 W
Exterior back draft shutter



PF-60
Cooker hood filter panel

CK-35N



Applications

The CK-35N centrifugal fan has been specifically designed to remove the smoke, odours and grease laden air generated from domestic cooking areas (350 m³/hr capacity).

The fan can be installed either inside or external to a kitchen cooker canopy. Model CK-35N incorporates a metallic grease filter to prevent the build-up of grease within the fan and ducting enclosures.

The fan operates with very low levels of noise and offers easy cleaning and maintenance access. The versatile design also enables the fan to be used in other ventilation applications that require the extraction of moist, odour and grease laden air.

Performance curve

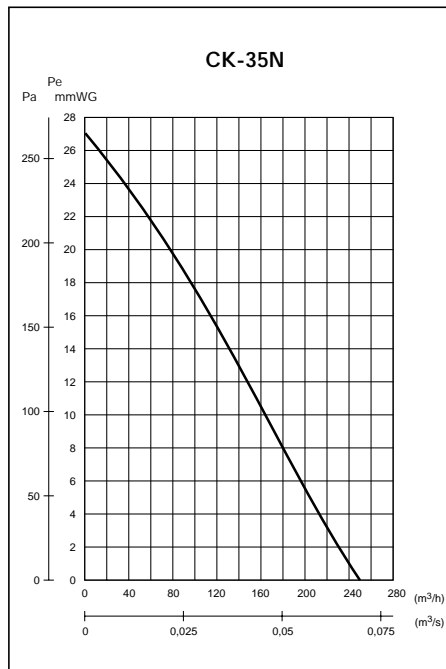

Technical characteristics

Model Type	Speed (r.p.m.)	Maximum power absorbed (W)	Voltage (V) 50 Hz	Maximum air flow (m ³ /h)	Sound pressure level (dB(A))*	Weight (kg)
CK-35N	2000	125	230	350	56	3,2

* At a 1,5 m distance.

Installation - Maintenance

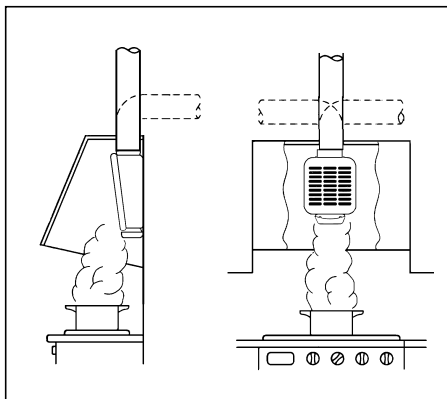

Dimensions (mm)

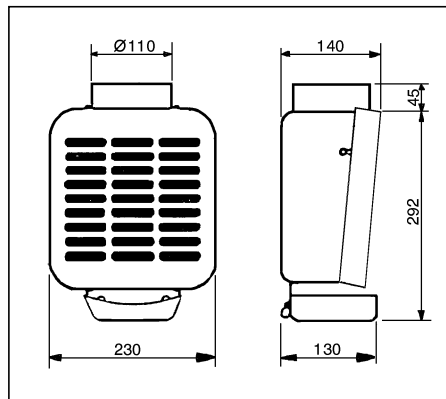

Accessories



REB
Single phase electronic fan speed control regulators



PER-160 W
Exterior back draft shutter



CM-130
In-duct back draft shutter



GSA-125
Flexible aluminium ducting



GRA-100
Aluminium exterior grill



PF-60
Cooker hood filter panel



CX-125
Worm drive ducting clips



CT-125
Roof Cowl

CK-40F



Applications

Centrifugal fan specifically designed to remove the smoke, odours and grease laden air generated from large domestic cooking areas, can be installed either inside or external to a kitchen cooker canopy. Fan CK-40F incorporates powerful centrifugal impellers which generate substantial pressure developments for use with long ducting runs. CK-40F incorporates a grease filter to improve efficiency and prevent the build-up of grease within the fan and ducting enclosures. It operates with very low levels of noise and offer easy cleaning and maintenance access.

Technical characteristics

Model Type	Speed (r.p.m.)	Maximum power absorbed (W)	Voltage (V) 50 Hz	Maximum air flow (m ³ /h)	Sound pressure level (dB(A))*	Weight (kg)
CK-40F	2350	70	230	360	55	2,7

* At a 1,5 m distance.

Installation - Maintenance

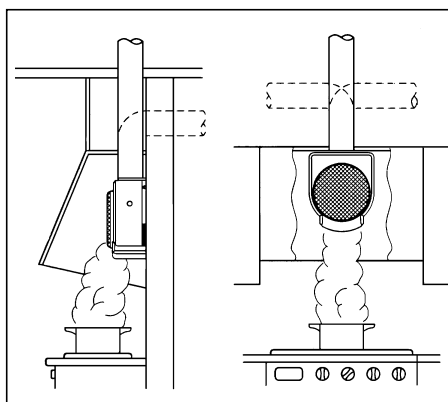

Accessories



REB
Single phase electronic fan speed control regulators



PER-160 W
Exterior back draft shutter



GSA-100
Flexible aluminium ducting



GRA-70
Aluminium exterior grill



CAR-100
Back draft shutter



PF-60
Cooker hood filter panel

Performance curve

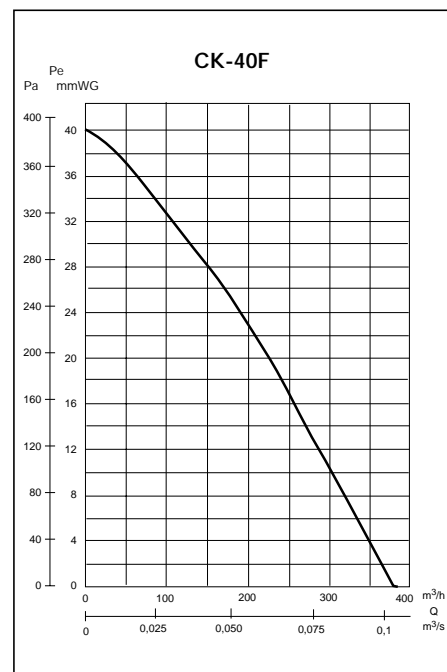

Dimensions (mm)

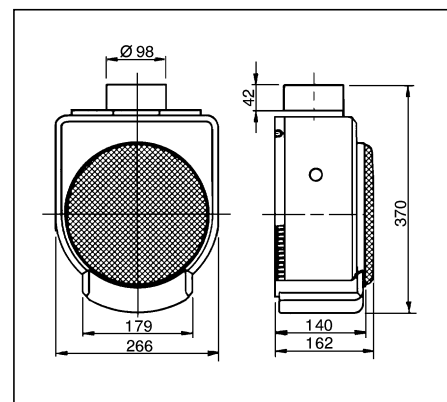

Kitchen extract kit CK-40F



The kit includes:

- CK-40F fan.
- 3m of GSA-100 flexible aluminium ducting.
- 2 duct connectors CX-80/125.
- In-line back draught shutter CM-130.

CK-50



Applications

The CK-50 centrifugal fan has been specifically designed to remove the smoke, odours and grease laden air generated from large domestic cooking areas (480 m³/hr capacity). The fan can be installed either inside or external to a kitchen cooker canopy. The CK-50 can be supplied with a metallic filter to replace the plastic inlet guard (please enquire). The CK-50 fan delivers high airflow performances (480 m³/hr) with the minimum levels of noise (52 dB) and offers easy access to parts for cleaning and maintenance. The versatile design also enables the fan to be used in other ventilation applications that require the extraction of moist, odour and grease laden air.

Performance curve

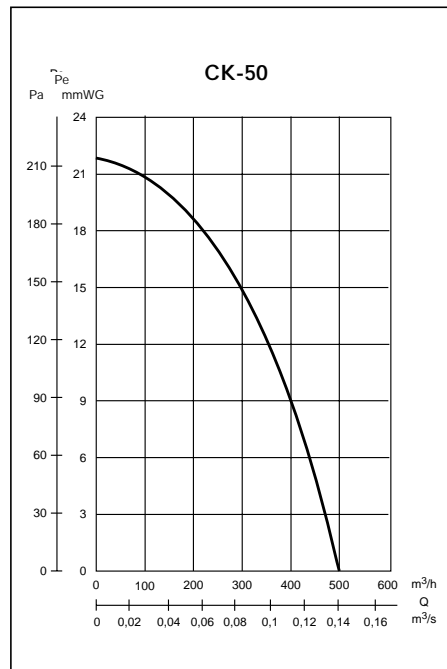

Technical characteristics

Model Type	Speed (r.p.m.)	Maximum power absorbed (W)	Voltage (V) at 50 Hz	Maximum air flow (m ³ /h)	Sound pressure level (dB(A))*	Weight (kg)
CK-50	1050	90	230	480	52	3,5

* At a 1,5 m distance.

Installation - Maintenance

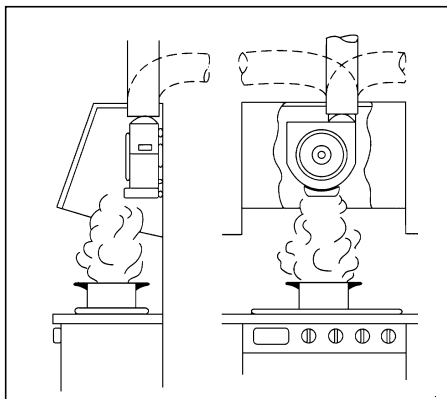

Dimensions (mm)

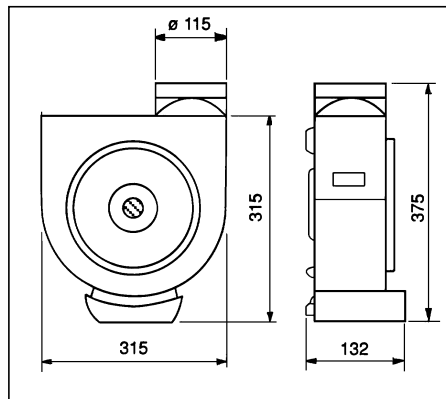

Accessories

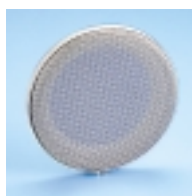

Metal inlet filter



CX-125
Worm drive ducting clips



CM-130
In-duct back draft shutter



REB
Single phase electronic fan speed control regulators



PER-160 W
Exterior back draft shutter



CT-125
Roof Cowl



GSA-125
Flexible aluminium ducting



GRA-100
Aluminium exterior grill



PF-60
Cooker hood filter panel

ECO-500



Applications

The ECO-500 centrifugal fan has been specifically designed to remove the smoke, odours and grease laden air generated from large domestic cooking areas (480 m³/hr capacity). The fan can be installed either inside or external to a kitchen cooker canopy. The ECO-500 can be supplied with a metallic filter to replace the plastic inlet guard (please enquire). The ECO-500 fan delivers high airflow performances (480 m³/hr) with the minimum levels of noise (52 dB) and offers easy access to parts for cleaning and maintenance. The versatile design also enables the fan to be used in other ventilation applications that require the extraction of moist, odour and grease laden air.

Performance curve

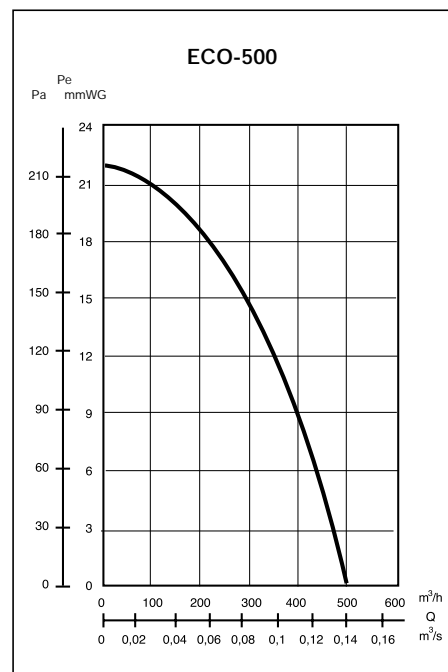

Technical characteristics

Model Type	Speed (r.p.m.)	Maximum power absorbed (W)	Voltage (V) at 50 Hz	Maximum air flow (m ³ /h)	Sound pressure level (dB(A))*	Weight (kg)
ECO-500	1050	90	230	480	52	3,5

* At a 1,5 m distance.

Installation - Maintenance

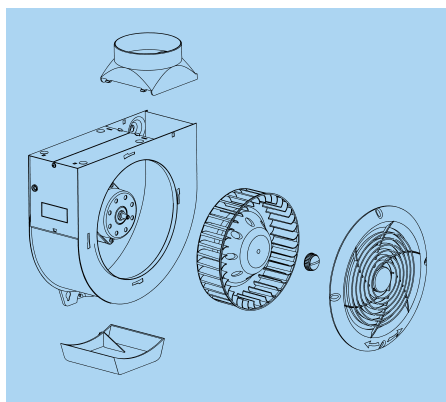
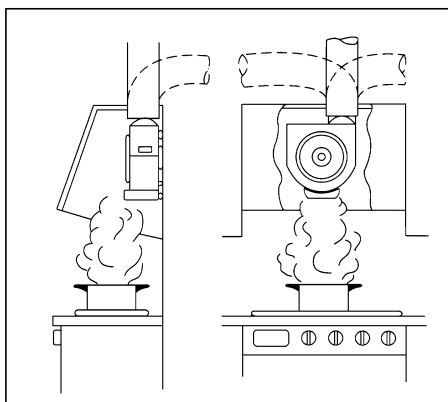

Dimensions (mm)

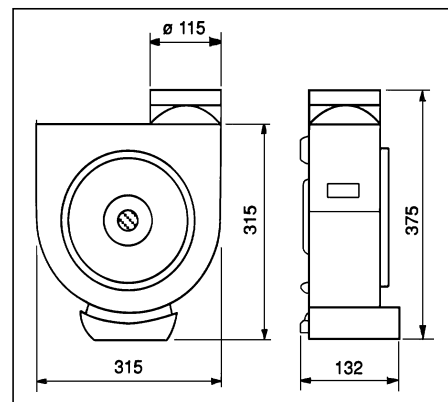

Accessories

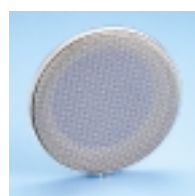

Metal inlet filter



CX-125
Worm drive ducting clips



CM-130
In-duct back draft shutter



REB
Single phase electronic fan speed control regulators



PER-160 W
Exterior back draft shutter



CT-125
Roof Cowl



GSA-125
Flexible aluminium ducting



GRA-100
Aluminium exterior grill



PF-60
Cooker hood filter panel

CK-60F



Applications

The CK-60F centrifugal fan has been specifically designed to remove the smoke, odours and grease laden air generated from large domestic cooking areas (625/415 m³/hr capacity). The fan can be installed either inside or external to a kitchen cooker canopy. The CK-60F is supplied with a stainless steel filter to prevent the build-up of grease within the fan and ducting enclosures.

The fan incorporates two speed operation as standard and offers easy access to parts for cleaning and maintenance access. The versatile design also enables the fan to be used in other ventilation applications that require the extraction of moist, odour and grease laden air.

Technical characteristics

Model Type	Speed (r.p.m.)	Maximum power absorbed (W)	Voltage (V) at 50 Hz	Maximum air flow (m ³ /h)	Sound pressure level (dB(A))*	Weight (kg)
CK-60F	VR	160	230	625	59	4,7
	VL	96		415	54	

* At a 1,5 m distance.

Installation - Maintenance

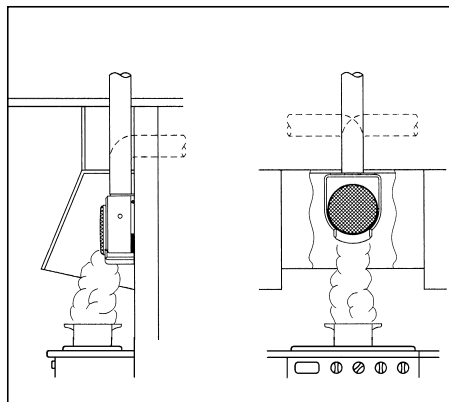

Accessories



REGUL-2
Two speed switches



GSA-125
Flexible aluminium ducting



CT-125
Roof cowls



PER-125 W
Exterior back draft shutter



GRA-100
Aluminium exterior grill



PF-60
Cooker hood filter panel

Performance curve

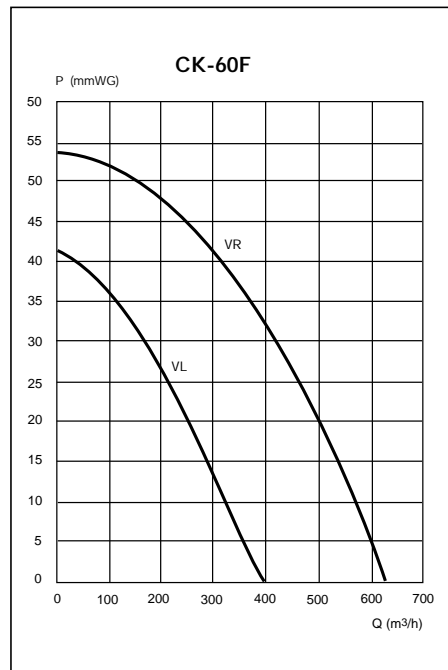

Dimensions (mm)

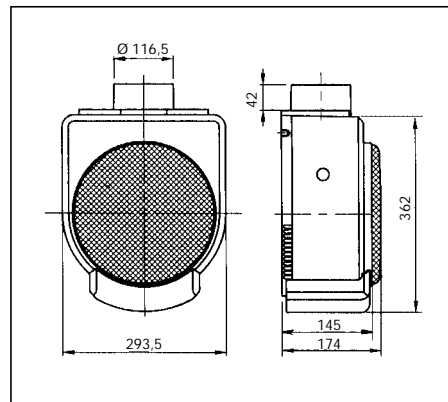

Kitchen extract kit CK-60F



The kit includes:

- CK-60F fan.
- 3m of GSA-125 flexible aluminium ducting.
- 2 duct connectors. CX-125/215.
- Two speed position switch. REGUL-2.