

SILENT Series
“RELAX IN PEACE
AND QUIET”



The world's most quiet
extractor fan in its class

26,5
dB



innovative solutions

BATHROOM EXTRACT FANS

SILENT-100

NEW



IP45!

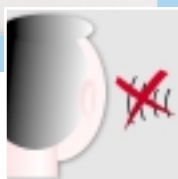

8W

Description

The Silent-100 offers the very lowest noise levels of any bathroom extract fan on the market today. All models include as standard an integrated back draft shutter; "Power-On" neon indication; single phase 230V 50Hz motors with ball bearings and "Silent Block", anti-vibration mountings; Class II electrical insulation; IP45 protection; Safety Thermal Overload Protection; and suitability for operating within temperatures up to +40°C.



Single Phase Motor with Anti-vibration Mounts. The motor is mounted on "Silent Block" anti-vibration mounts to prevent any vibrations and therefore noise transmission.

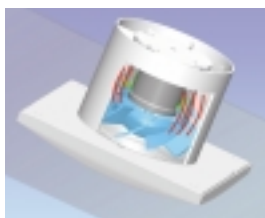

Silent-100 series - Silent Operation

In traditional extract fans any vibrations are transmitted to the surrounding areas. In the Silent-100 series any vibrations are absorbed by the motor Silent Blocks resulting in the quietest bathroom extract fan on the market today.



Back draft Shutter. When the fan is not operating the back draft shutter prevents the entry of air from the outside and also the escape of heated air from the inside. When the fan is operating the back draft shutter opens to enable the efficient extract of air.

Functions / Models

| | CZ | CRZ | CHZ | CRIZ | CDZ | CZ (12V) | CZ SILVER | CRZ SILVER |
|------------------------|----|-----|-----|------|-----|----------|-----------|------------|
| Pilot light | • | • | • | • | • | • | | |
| Anti-return gate | • | • | • | • | • | • | • | • |
| Adjustable timer(1-30) | | • | • | • | • | | | • |
| Delayed start 50" | | | | • | | | | |
| Adjustable humidistat | | | • | | | | | |
| PIR detector | | | | | • | | | |
| Ball bearings | • | • | • | • | • | • | • | • |
| Silver colour | | | | | | | • | • |

Dimensions (mm)

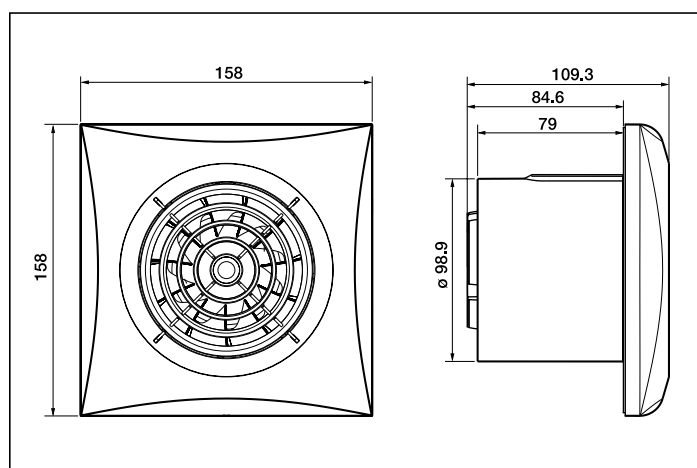

Performance curve

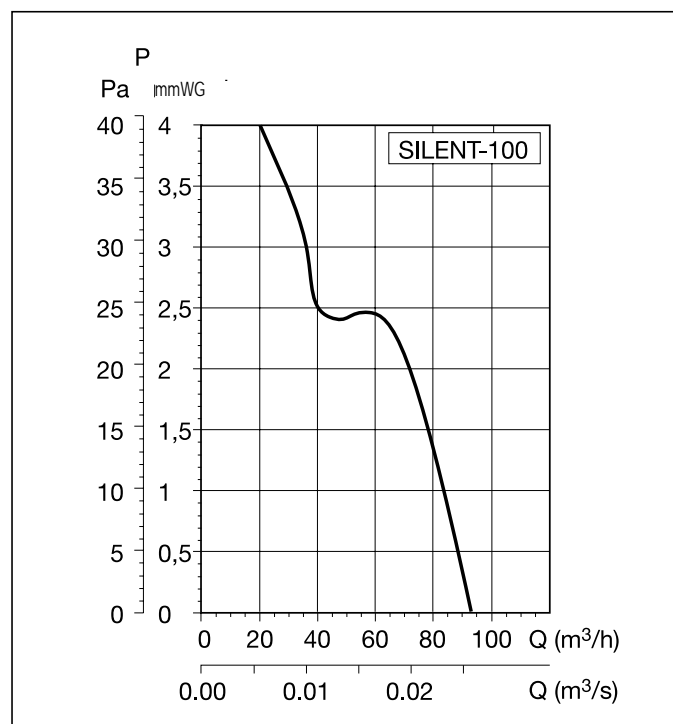

Technical characteristics

| Type | Speed (r.p.m.) | Free discharge absorbed power (W) | Voltage (V) 50 Hz | Sound pressure level* (dB(A)) | Duty at free discharge (m³/h) | Insulation/ IP | Weight (kg) |
|----------------|----------------|-----------------------------------|-------------------|-------------------------------|-------------------------------|----------------|-------------|
| SILENT-100 | 2400 | 8 | 230 | 26,5 | 95 | II / IP-45 | 0,57 |
| SILENT-100 12V | 2400 | 8 | 12 | 26,5 | 95 | II / IP-57 | 0,57 |

* Radiated sound level measured at 3 m from ducting product at free air conditions.

SILENT-100 CDZ

NEW



■ Applications

This model is provided with a PIR (passive infra-red) detector. The unit starts automatically when a movement is detected within a maximum distance of 4 meters. They are also fitted with an adjustable "run on" timer (1 to 30 minutes), and the unit will continue to operate for the set period after initiation of the movement detector



SILENT-100 CZ 12V

NEW



■ Applications

The SILENT-100 12V is designed for operation at SELV(Safety Extra Low Voltage), allowing it to be installed within the shower or bath volume with total safety. It must be wired to a safety transformer CT-12/14 or CT-12/14R.



Transformer CT-12/14
Safety isolating transformer which must be used with the EDM-100-12V fans and should be located out of the reach of the water spray or person using a bath or shower.

- Supply Voltage / Output Voltage: 230V / 12V 50Hz single phase.
- IP21. Class II double insulated appliance.
- Incorporates an internal fuse (replaceable).

Transformer CT-12/14 R
With adjustable run-on-timer (1-30 minutes).

SILENT-100 SILVER models

NEW



Silvershiny colour models, very elegant, aesthetically pleasing.

■ Accessories



GSA-100
Flexible aluminium duct



GRA-70
Exterior aluminium grille



PER W-100
Back draft shutter



CX-215
Worm drive ducting clips



BATHROOM EXTRACT FANS

SILENT-300

NEW

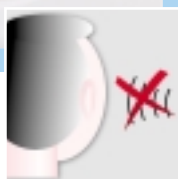

IP45!

Description

The Silent-300 offers the very lowest noise levels for the extraction of odours and moisture from toilets, bathroom and small rooms. All models include as standard an integrated back draft shutter; "Power-On" neon indication; single phase 230V 50Hz motors with ball bearings and "Silent Block", anti-vibration mountings; Class II electrical insulation; IP45 protection; Safety Thermal Overload Protection; and suitability for operating within temperatures up to +40°C.

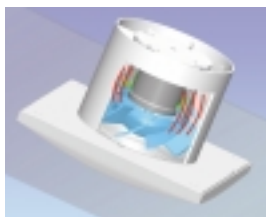

Silent-300 series - Silent Operation

In traditional extract fans any vibrations are transmitted to the surrounding areas. In the Silent-300 series any vibrations are absorbed by the motor Silent Blocks resulting in the quietest bathroom extract fan on the market today.



Single Phase Motor with Anti-vibration Mounts. The motor is mounted on "Silent Block" anti-vibration mounts to prevent any vibrations and therefore noise transmission.



Back draft Shutter. When the fan is not operating the back draft shutter prevents the entry of air from the outside and also the escape of heated air from the inside. When the fan is operating the back draft shutter opens to enable the efficient extract of air.

Functions / Models

| | CZ | CRZ | CHZ | CZ PLUS | CRZ PLUS |
|------------------------|----|-----|-----|---------|----------|
| Pilot light | • | • | • | • | • |
| Anti-return gate | • | • | • | • | • |
| Adjustable timer(1-30) | | • | • | | • |
| Adjustable humidistat | | | • | | |
| Ball bearings | • | • | • | • | • |
| Higher performances | | | | • | • |

Dimensions (mm)

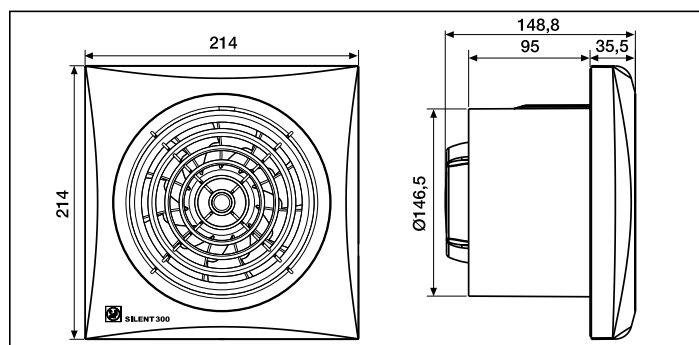

Performance curve

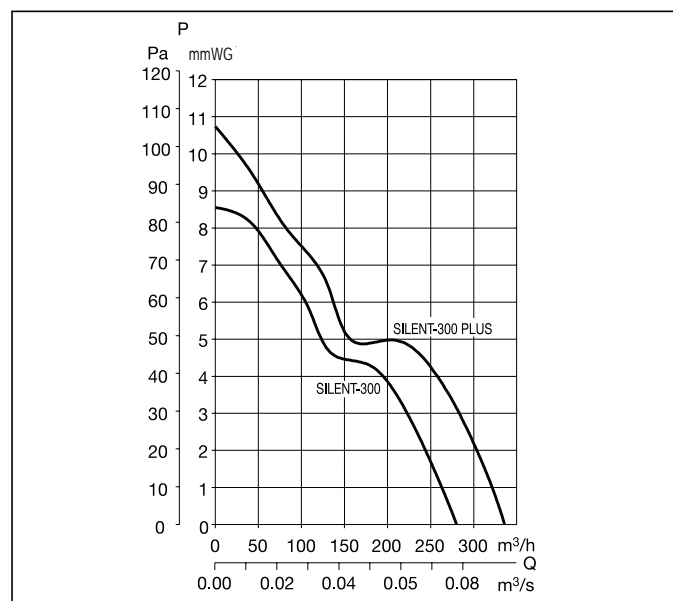

Technical characteristics

| Type | Speed (r.p.m.) | Free discharge absorbed power (W) | Voltage (V) 50 Hz | Sound pressure level* (dB(A)) | Duty at free discharge (m³/h) | Insulation/ IP | Weight (kg) |
|-----------------|----------------|-----------------------------------|-------------------|-------------------------------|-------------------------------|----------------|-------------|
| SILENT-300 | 1700 | 29 | 230 | 30 | 280 | II / IP-45 | 1,25 |
| SILENT-300 PLUS | 2000 | 17 | 230 | 36 | 320 | II / IP-45 | 1,65 |

* Radiated sound level measured at 3 m from ducting product at free air conditions.

Accessories



GSA-150
Flexible aluminium duct



GRA-150
Exterior aluminium grille



PER W-160
Back draft shutter



CX-215
Worm drive ducting clips

SILENT

Bathroom extract fans